

Stand-on platform with lateral side restraints for excellent ergonomics and productivity.

Compact design for optimal space utilization and maneuverability.

Redesigned smartPILOT for improved ergonomics and intuitive operation.

Sensor-activated speed reduction for reliable truck-trailer entry (optional).



ERE 125i

Electric pedestrian pallet truck (5,500 lb.)

Variable and versatile for a wide range of applications.

The flexible and powerful ERE 125i electric ride-on pallet trucks combine proven technology with innovative features specifically tailored to the demands of modern warehouse logistics. The wide variety of stand-on platforms offer custom solutions for different application scenarios. The compact design, with a reduced front end length, allows optimal

utilization of warehouse space and improves maneuverability in confined spaces. With their modular system, these trucks are extremely flexible and can adapt perfectly to your individual requirements. With a variety of added features, the pallet truck can be configured to help meet your application requirements.

The revised smartPILOT allows operation from both sides with automatic centre positioning. Optimized access to the comfort charging socket ensures added user experience. These innovative features enhance efficiency, ergonomics in your warehouse.

 **JUNGHEINRICH®**

ERE 125i

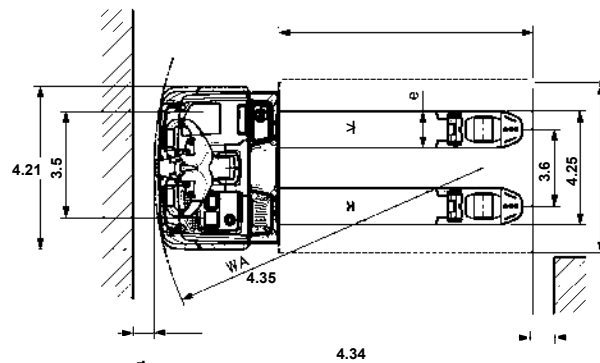
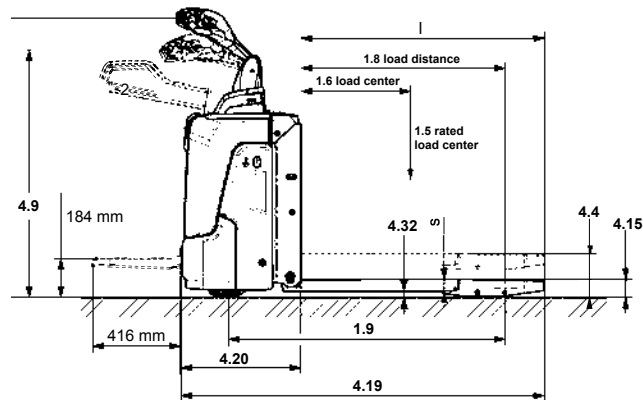
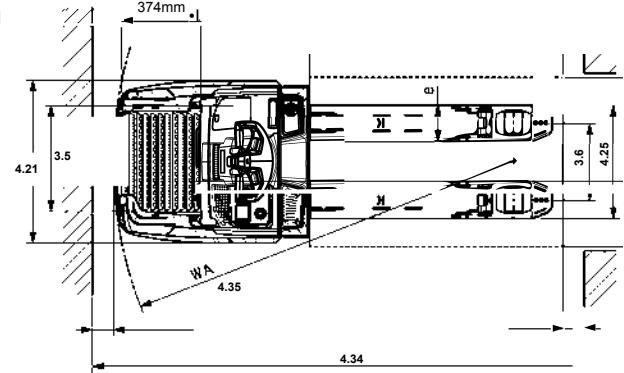
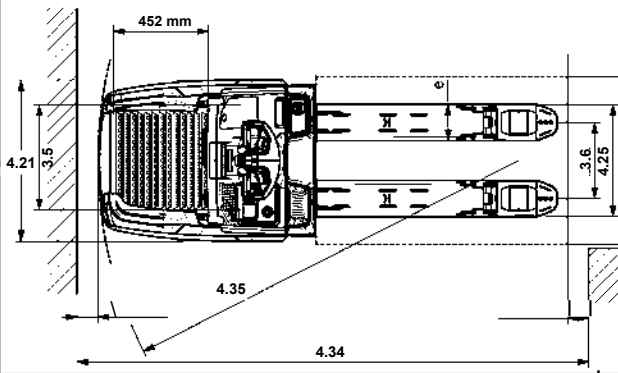
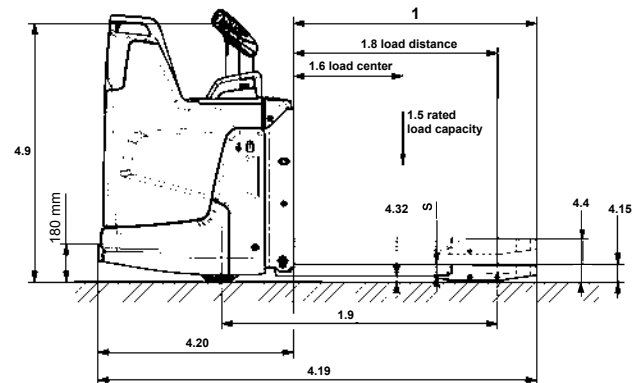
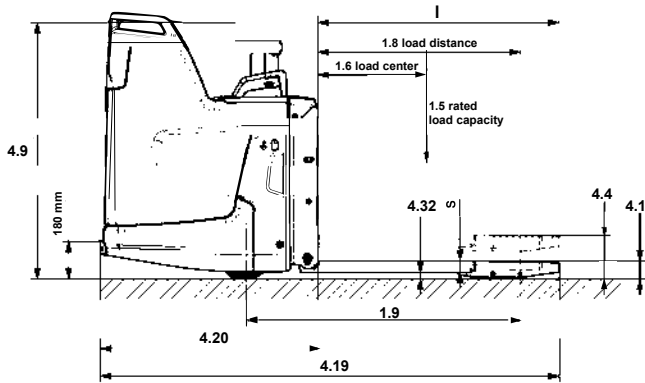

Technical data

as of: 07/2025

| | | | | | | | | | | |
|-----------------|--|---|-----------------|-----------------|-----------------------|------------------------|------------------------|-------------------|-----------------------|--|
| Characteristics | 1.1 | Manufacturer | | | | Jungheinrich | | | | |
| | 1.2 | Model | | | | ERE 125i | | | | |
| | 1.3 | Drive | | | | electric | | | | |
| | 1.4 | Type of operation | | | | tiller | | | | |
| | 1.5 | Load capacity / rated load | Q | lb | kg | 5,512 | | 2,500 | | |
| | 1.6 | Load center distance | c | in | mm | 24 | | 600 | | |
| | 1.8 | Load distance | x | in | mm | 35.3 ⁴⁾ | | 897 ⁴⁾ | | |
| 1.9 | Wheelbase | y | in | mm | 48.7 ^{4) 6)} | | 1,237 ^{4) 6)} | | | |
| Weights | 2.1.1 | Service weight including battery | | lb | kg | 1,235 | | 560 | | |
| | 2.2 | Axle loading, loaded front / rear | | lb | kg | 4,209 | 2,546 | 1,909 | 1,155 | |
| | 2.3 | Axle loading, no load, load / drive | | lb | kg | 302 | 933 | 137 | 423 | |
| Wheels, Chassis | 3.1 | Tires | | | | polyurethane (PU) | | | | |
| | 3.2 | Tire size (drive) | d ₁ | in | mm | Ø 230 x 77 | | | | |
| | 3.3 | Tire size (load) | d ₂ | in | mm | Ø 85 x 110 / Ø 85 x 85 | | | | |
| | 3.4 | Tire size (caster) | | in | mm | Ø 140 x 57 | | | | |
| | 3.5 | Wheels, number, drive / caster / load ⁷⁾ | | | | 1 / 2 / 2 | | | | |
| | 3.6 | Tread width, front | b ₁₀ | in | mm | 14.3 | | 363 | | |
| | 3.7 | Tread width, rear | b ₁₁ | in | mm | 20.2 | | 512 | | |
| Dimensions | 4.4 | Maximum fork height from ground | | h ₃ | in | mm | 8.1 | | 207 | |
| | 4.9 | Height of tiller handle in drive position min./max. | | h ₄ | in | mm | 44.8 / 55.9 | | 1,137 / 1,419 | |
| | 4.15 | Lowered fork height | | h ₁₃ | in | mm | 3.3 | | 85 | |
| | 4.19 | Overall length ^{2) 3) 5) 6)} | | l ₁ | in | mm | 67.6 | | 1,716 | |
| | 4.20 | Length to fork face ^{2) 3) 5) 6)} | | l ₂ | in | mm | 22.3 | | 566 | |
| | 4.21.1 | Overall width | | b ₂ | in | mm | 30.3 | | 770 | |
| | 4.22 | Fork dimensions – thickness / width ¹⁾ | | s / e / l | in | mm | 2.2 / 6.8 / 45.3 | | 55 x 172 x 1,150 | |
| | 4.25 | Overall width across forks | | b ₅ | in | mm | 20 / 21 / 22 / 27 | | 510 / 535 / 550 / 670 | |
| | 4.32 | Ground clearance center of wheelbase | | m ₂ | in | mm | 1.2 | | 30 | |
| | 4.34 | Aisle width for right angle stack (40 x 48 inch pallet lengthways) ^{2) 3) 5) 6)} | | Ast | in | mm | 79.2 | | 2,011 | |
| 4.35 | Minimum outside turning radius ^{2) 3) 4) 5) 6)} | | Wa | in | mm | 58.6 | | 1,489 | | |
| Performance | 5.1 | Travel speed, loaded / no load | | mph | km/h | 5.6 / 5.6 | | 9.0 / 9.0 | | |
| | 5.2 | Lift speed, loaded / no load | | fpm | m/s | 11.8 / 15.7 | | 0.06 / 0.08 | | |
| | 5.3 | Lowering speed, loaded / no load | | fpm | m/s | 13.8 / 9.8 | | 0.07 / 0.05 | | |
| | 5.8 | Maximum gradeability loaded / no load | | % | | 8 / 16 | | | | |
| | 5.10 | Brakes – service | | electric | | | | | | |
| Electrical | 6.1 | Drive motor performance S ₂ 60 min. | | | HP | kW | 3.8 | | 2.8 | |
| | 6.2 | Lift motor rating at S ₃ | | | HP | kW | 3.0 | | 2.2 | |
| | 6.4 | Battery voltage / nominal ⁸⁾ | | | Volts | Ah | 25.6 | | 100 | |
| | 6.5 | Integrated Battery Weight ⁸⁾ | | | lb | kg | 77 | | 35 | |
| | 6.6.1 | Energy consumption according to DIN EN 16796 | | | kWh/h | | 0.36 | | | |
| | 6.6.2 | CO ₂ equivalent as per EN 16796 | | | kg/h | | 0.2 | | | |
| | 6.7 | Turnover output according to VDI 2198 | | | US t/h | t/h | 215 | | 195 | |

- 1) Additional dimensions / sizes available
- 2) For folding platform configuration, + 16.4 in. (416 mm) when platform folded down
- 3) For fixed platform (compact), + 14.1 in. (358 mm)
- 4) Load section lowered: + 2.6 in. (67 mm)
- 5) With fixed platform (extended): + 18.6 in. (472 mm)
- 6) With S battery compartment: + 2.0 in. (50 mm)
- 7) Tandem load wheel optional
- 8) Power pack offerings: 100Ah 35kg (77 lbs.); 150Ah 47kg (104 lbs.); 200Ah 56kg (122 lbs.)

Note: Equipping this model (these models) with a power source (e.g. Lithium-ion, Hydrogen Fuel cell, etc.) that has not been previously approved by the factory is considered a modification. Per OSHA 1910.178 and ANSI/ITSDF B56.1, please consult with your factory representative prior to installing any non-OEM power source that has not been previously approved.

The Jungheinrich Advantage



Efficiency

Maximum performance thanks to innovative technology.

The battery concept offers a high degree of flexibility and adapts to your storage needs. The lithium-ion technology remains efficient even at low temperatures in cold-store applications. Jungheinrich-produced lithium-ion battery has LFP (Lithium-iron Phosphate) chemistry for optimized efficiency.

Flexible battery concept

- High capacity and adaptability from 100 Ah to 200 Ah.
- Powerful 35-A built-in charger for booster charging at any socket, even during short breaks.
- High availability thanks to short charging times.

Powerful drive concept

- Powerful acceleration and high top speed.
- Greater driving performance with load-dependent curveCONTROL.
- Regenerative braking with energy recovery.

Ergonomic solutions

- Trailer Detection Sensor System with automatic speed reduction when driving into trailers minimizes impacts and increases driving comfort.
- Platform suspension can be adjusted according to the weight of the operator.
- Generous space with sidestanding design promotes healthy posture.
- Optional comfort charging socket increases ease of use.



Control

High level of safety for employees and goods.

The ergonomic stand-on platform provides restraint and protection while providing plenty of space for the operator. Intelligent assistance systems help increase productivity.

Intelligent assistance systems

- 15% increase in productivity thanks to the optional positionCONTROL – lift times are reduced using predefined lift heights, while at the same time free lift of the pallet is achieved by means of a single lift.
- High load stability due to coupling of the support wheels (ProTracLink).
- Sensor with enclosed space detection for automatically reducing speed when entering the truck-trailer.
- Floor-Spot mounted within the truck contour.

Additional features

- High variety of stand-on platforms with spacious design.
- Additionally cushioned stand-on platform with driver weight dependent adjustment.
- Optimized cornering speed due to curveCONTROL.
- Improved visibility in poorly lit areas thanks to optional spotlight on the options bracket.



Individuality

Can be adapted to a wide range of applications.

With numerous customization options, you can design the equipment according to your needs – from increased efficiency and additional features to ergonomic solutions.

Individually adjustable

- Different stand-on platform variants to satisfy individual requirements.
- Adaptable travel program pre-sets with speeds up to 5.6 mph (9 km/h).
- Capacity up to 5,500 lbs. (2.5 t).
- Extensive accessories for individual tailoring.
- Sturdy, universal options bracket, e.g. for radio data transmission components.
- Optional sprung stand-on platform reduces vibration felt by the operator.
- New 72-inch load backrest offering.

Parts when you need them

- Jungheinrich's Parts Fast or Parts Free Guarantee ensures next-business-day delivery by 5:00 PM of all Jungheinrich parts in the United States, or they're free, including freight. For customers in Canada and Mexico, the guarantee ensures shipping of parts within 24 hours from the time the order was placed by the dealer. See your local Jungheinrich dealer for program details.

* Programs may be subject to change without notice and may vary by region. Please ask your local Jungheinrich dealer for complete terms and conditions.

** The product shown may be different than the actual configuration based on market requirements.